

## SKIRTING SHADOW SERIES

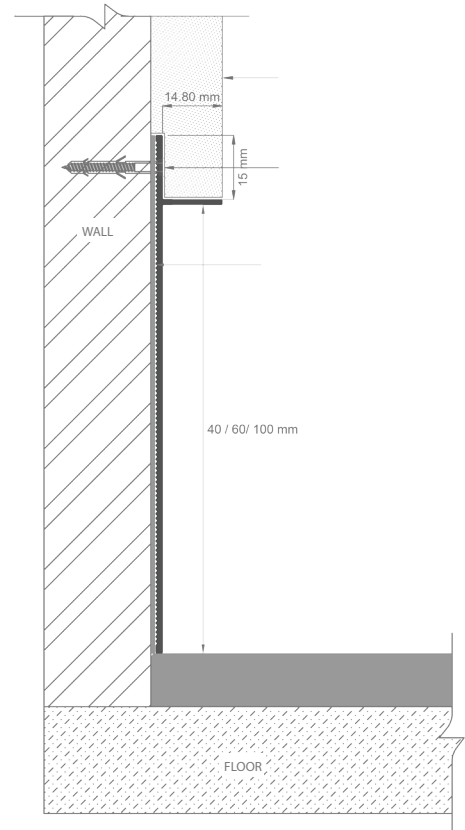

Size	Product Code
40 mm	SKTAL 1031
60 mm	SKTAL 1032
100 mm	SKTAL 1033

Standard Length
3048mm per profile

Available in different finishes – Anodizing, Powder Coating, PVDF and Wooden Finish.  
Available in silver and black shade. Custom shades available on demand.



### Key Features

- **Contemporary Aesthetic** – Enhances modern interiors with a sleek finish.
- **High-Quality Aluminium** – Corrosion-resistant and long-lasting durability.
- **Easy Installation** – Designed for quick and smooth fitting.
- **Hygienic & Low Maintenance** – Prevents dust accumulation and simplifies cleaning.
- **Enhanced Protection** – Shields walls from impact, scratches, and moisture.

### Ideal Applications

- **Commercial Spaces** – Ideal for offices, retail outlets, and hotels.
- **Residential Use** – Perfect for living spaces, kitchens, and hallways.
- **Healthcare & Institutional Buildings** – Used in hospitals, schools, and malls.